

- NOTES:
- RADON PIPE CAN BE VENTED THROUGH CEILING/ROOF TO THE EXTERIOR OR THROUGH FOUNDATION WALL TO THE EXTERIOR. EXHAUST FAN MUST BE LOCATED NEAR THE OUTLET.
 - THE FOLLOWING REQUIREMENTS ARE THE SUGGESTED MINIMUM SETBACKS/CLEARANCES FROM A PASSIVE RADON STACK TERMINATION CLEARANCE FOR ROOF TOP DISCHARGE:
 - VERTICAL CLEARANCE ABOVE THE ROOF AT THE POINT OF PENETRATION 1 FT. (0.3M)
 - VERTICAL CLEARANCE ABOVE WINDOWS OR DOORS 2 FT. 0.6 M
 - VERTICAL CLEARANCE ABOVE MECHANICAL AIR SUPPLY INLET (AIR INTAKE) 3 FT. (0.9M)
 - HORIZONTAL CLEARANCE FROM WINDOWS, DOORS, OR MECHANICAL AIR SUPPLY INLET 10 FT. (3.0M)
 - CLEARANCE HORIZONTALLY FROM A VERTICAL WALL THAT EXTENDS ABOVE THE ROOF PENETRATED 10 FT. (3.0M)
 - THE FOLLOWING REQUIREMENTS ARE THE SUGGESTED MINIMUM SETBACKS/CLEARANCES FOR ACTIVE RADON REDUCTION SYSTEMS:
 - CLEARANCE TO A MECHANICAL AIR SUPPLY INLET MIN. 6-1/2 FT., SUGGESTED 10 FT. (2.0M, 3.0M)
 - CLEARANCE TO PERMANENTLY CLOSED WINDOW MIN. 2 FT, SUGGESTED 3-1/2 FT. (0.6M, 1.0M)
 - CLEARANCE TO A OPENABLE WINDOW MIN./SUGGESTED 6-1/2 FT. (2.0M)
 - CLEARANCE FROM A DOOR THAT MAY BE OPENED MIN. 3-1/2 FT., SUGGESTED 6-1/2 FT. (1.0M, 2.0M)
 - CLEARANCE TO OUTSIDE CORNER MIN./SUGGESTED 1 FT. (0.3M)
 - CLEARANCE TO INSIDE CORNER MIN./SUGGESTED 1 FT. (0.3M)
 - CLEARANCE ABOVE PAVED SIDEWALK OR PAVED DRIVEWAY LOCATED ON PUBLIC PROPERTY MIN./SUGGESTED 6-1/2 FT. (2.0M)
 - CLEARANCE ABOVE GRADE, VERANDA, PORCH, DECK, OR BALCONY MIN. 1 FT., SUGGESTED 3-1/2 FT. (0.3M, 1.0M)
 - VERTICAL CLEARANCE BELOW SOFFITS OR FROM ANY ATTIC VENTING COMPONENT MIN./SUGGESTED 3-1/2 FT. (1.0M)
 - HORIZONTAL CLEARANCE FROM AN AREA DIRECTLY BELOW THE DISCHARGE WHERE THERE IS A RISK OF INJURY FROM ICE FALL MIN. 3-1/2 FT., SUGGESTED 6-1/2 FT. (1.0M, 2.0M)
 - THE COMPLETION OF A SUBFLOOR DEPRESSURIZATION SYSTEM MAY BE NECESSARY TO REDUCE THE RADON CONCENTRATION TO A LEVEL BELOW THE GUIDELINE SPECIFIED BY HEALTH CANADA.
 - FURTHER INFORMATION ON PROTECTION FROM RADON INGRESS CAN BE FOUND IN THE FOLLOWING HEALTH CANADA PUBLICATIONS:
 - RADON: A GUIDE FOR CANADIAN HOMEOWNERS (CMHC/HC), &
 - RADON: REDUCTION GUIDE FOR CANADIANS, &
 - GUIDE FOR RADON MEASUREMENTS IN RESIDENTIAL DWELLINGS (HOMES)

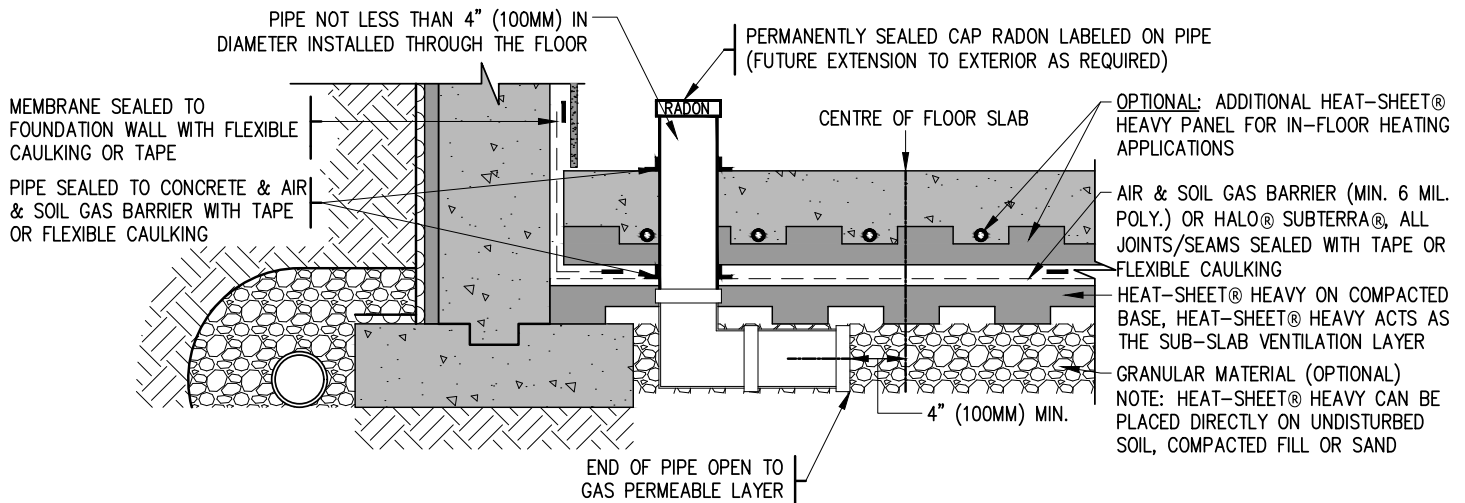



NOTES:

- RADON PIPE CAN BE VENTED THROUGH CEILING/ROOF TO THE EXTERIOR OR THROUGH FOUNDATION WALL TO THE EXTERIOR. EXHAUST FAN MUST BE LOCATED NEAR THE OUTLET.
- THE FOLLOWING REQUIREMENTS ARE THE SUGGESTED MINIMUM SETBACKS/CLEARANCES FROM A PASSIVE RADON STACK TERMINATION CLEARANCE FOR ROOF TOP DISCHARGE:
 - VERTICAL CLEARANCE ABOVE THE ROOF AT THE POINT OF PENETRATION 1 FT. (0.3M)
 - VERTICAL CLEARANCE ABOVE WINDOWS OR DOORS 2 FT. 0.6 M
 - VERTICAL CLEARANCE ABOVE MECHANICAL AIR SUPPLY INLET (AIR INTAKE) 3 FT. (0.9M)
 - HORIZONTAL CLEARANCE FROM WINDOWS, DOORS, OR MECHANICAL AIR SUPPLY INLET 10 FT. (3.0M)
 - CLEARANCE HORIZONTALLY FROM A VERTICAL WALL THAT EXTENDS ABOVE THE ROOF PENETRATED 10 FT. (3.0M)
- THE FOLLOWING REQUIREMENTS ARE THE SUGGESTED MINIMUM SETBACKS/CLEARANCES FOR ACTIVE RADON REDUCTION SYSTEMS:
 - CLEARANCE TO A MECHANICAL AIR SUPPLY INLET MIN. 6-1/2 FT., SUGGESTED 10 FT. (2.0M, 3.0M)
 - CLEARANCE TO PERMANENTLY CLOSED WINDOW MIN. 2 FT, SUGGESTED 3-1/2 FT. (0.6M, 1.0M)
 - CLEARANCE TO A OPENABLE WINDOW MIN./SUGGESTED 6-1/2 FT. (2.0M)
 - CLEARANCE FROM A DOOR THAT MAY BE OPENED MIN. 3-1/2 FT., SUGGESTED 6-1/2 FT. (1.0M, 2.0M)
 - CLEARANCE TO OUTSIDE CORNER MIN./SUGGESTED 1 FT. (0.3M)
 - CLEARANCE TO INSIDE CORNER MIN./SUGGESTED 1 FT. (0.3M)
 - CLEARANCE ABOVE PAVED SIDEWALK OR PAVED DRIVEWAY LOCATED ON PUBLIC PROPERTY MIN./SUGGESTED 6-1/2 FT. (2.0M)
 - CLEARANCE ABOVE GRADE, VERANDA, PORCH, DECK, OR BALCONY MIN. 1 FT., SUGGESTED 3-1/2 FT. (0.3M, 1.0M)
 - VERTICAL CLEARANCE BELOW SOFFITS OR FROM ANY ATTIC VENTING COMPONENT MIN./SUGGESTED 3-1/2 FT. (1.0M)
 - HORIZONTAL CLEARANCE FROM AN AREA DIRECTLY BELOW THE DISCHARGE WHERE THERE IS A RISK OF INJURY FROM ICE FALL MIN. 3-1/2 FT., SUGGESTED 6-1/2 FT. (1.0M, 2.0M)
- THE COMPLETION OF A SUBFLOOR DEPRESSURIZATION SYSTEM MAY BE NECESSARY TO REDUCE THE RADON CONCENTRATION TO A LEVEL BELOW THE GUIDELINE SPECIFIED BY HEALTH CANADA.
- FURTHER INFORMATION ON PROTECTION FROM RADON INGRESS CAN BE FOUND IN THE FOLLOWING HEALTH CANADA PUBLICATIONS:
 - RADON: A GUIDE FOR CANADIAN HOMEOWNERS (CMHC/HC), &
 - RADON: REDUCTION GUIDE FOR CANADIANS, &
 - GUIDE FOR RADON MEASUREMENTS IN RESIDENTIAL DWELLINGS (HOMES)

©Copyright Logix Brands Ltd. (Year of Publishing) All rights reserved. No part of the work contained herein as covered by this copyright may be reproduced or used in any form, or any means - graphic, electronic or mechanical, including without limitation photocopying.

By using these drawings, you agree to assume all risks associated therewith. See Logixbrands.com/Disclaimer-Drawings

Drawing:
3-3

Date:
JUNE/2023

Pg:
3

